

Threading the upper thread of the Bernina 830E/820

If you would like to download the file and print it ...Please click here

If you own a Bernina 830E/820 you **MUST** read this. This is the most important article you read in a long time.. And you think I'm kidding eh?

This is the **ONLY** and **CORRECT** way to thread your fantastic machine!

You may all think you know **how to thread** your new machine correctly, am I right? Well then, I will only point out to you the "stuff" your dealer may not have told you or you may have forgotten!!

As always... Let's start!

1. **Your machine has to be turned on! You CAN NOT thread your machine without having the power on!**

Feed the thread into the guide (red) on the side of the machine like you see it in the picture. This activates the machines threading procedure. The blue arrow indicates the thread in my right hand! I hold it tight like a tension.



2. As the left hand guides the thread in the slot on top of the machine and comes around on the left side of the machine, the right hand is holding the thread tight. What I mean by is that the thread is "slipping" trough your fingers but you have tension on it. If you do not have tension on the thread, you will not be able to thread your take-up-lever, who is hidden behind the "service cover"! In the pictures below I took the service cover off to show you what you are "doing" when threading the machine.

The red arrow is pointing at your take up lever. As you can see the thread is automatically threaded. The second picture shows you a close up how the thread is moving behind the wire on the take-up-lever.

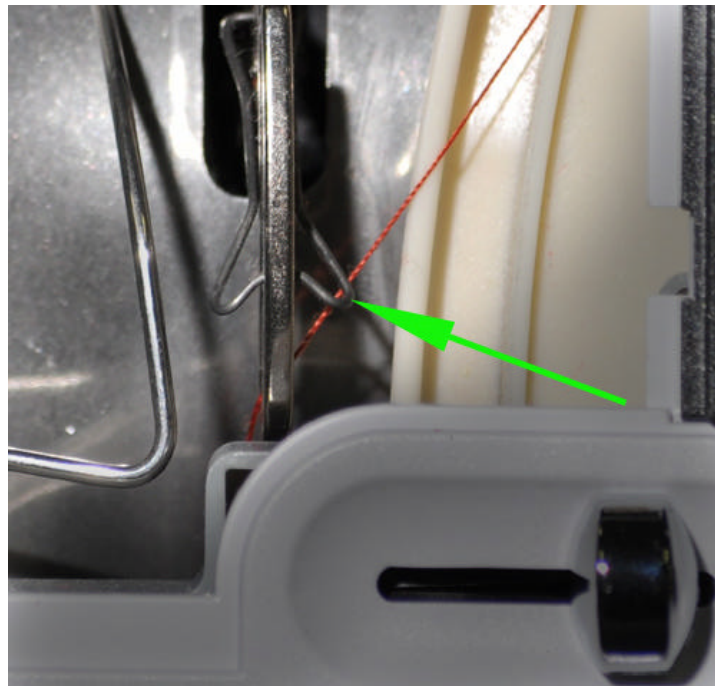
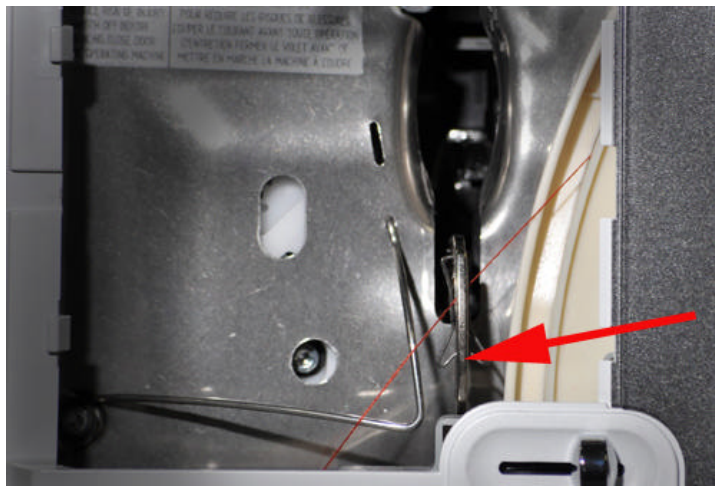

3. *Even after this point, your right hand is still putting tension on the thread! You are now at the bottom of your machine and ready to slip the thread behind the thread guide on the needle bar. Once again the second picture will provide you with a close up for you to see that the thread is going behind the wire!*

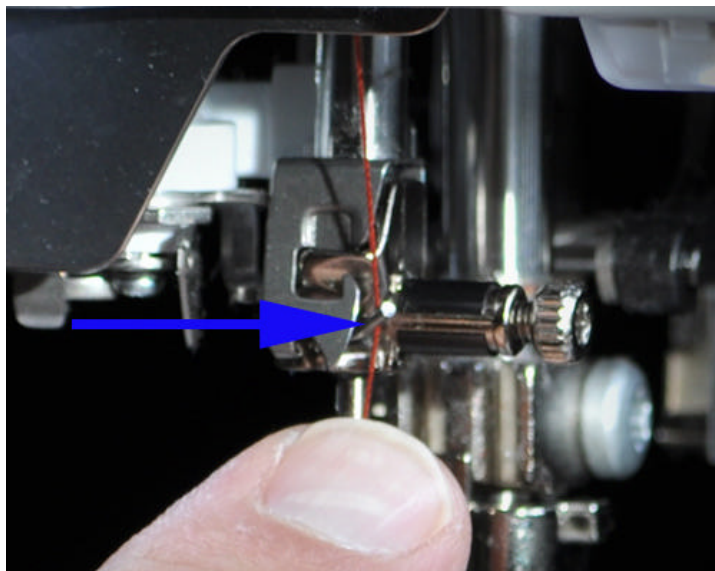

4. **Now it's time for you to let the thread go in your right hand, no more tension is needed at this point!**

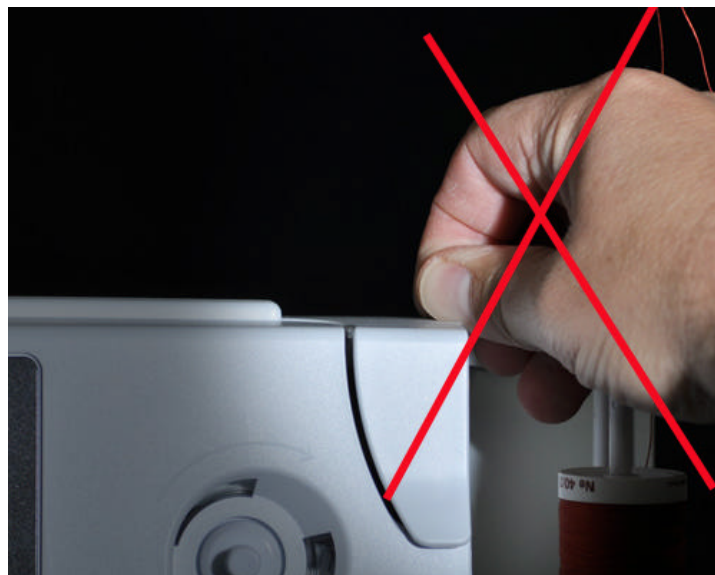

5. You feed the thread between those two plastic pieces.

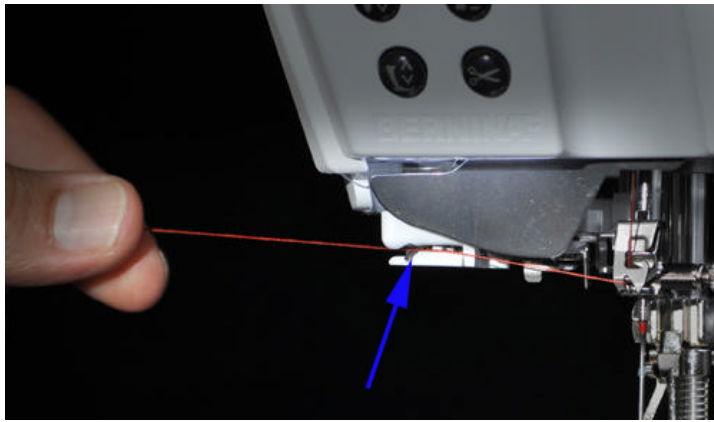

6. At the side of your machine you run the thread around the thread cutter and cut the thread. Please take a very good look the arrow in the picture below. The thread is on the right side of the white plastic part where the green arrow is pointing at!

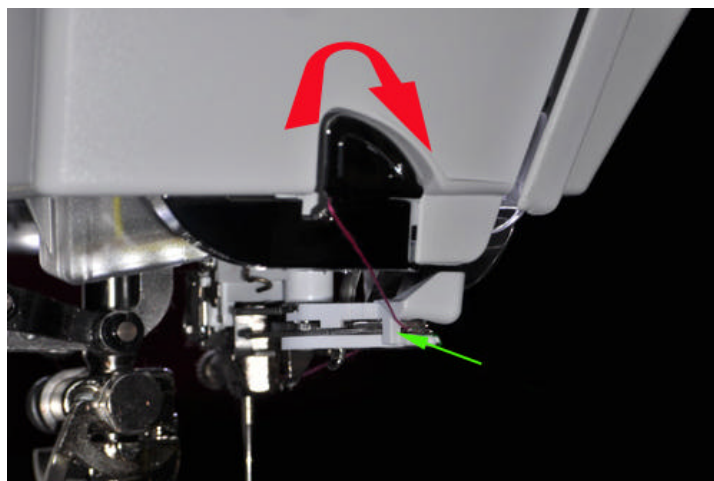

7. Now push the button on the front of your machine, and your machine will do the rest and thread your needle.

[Home](#)

As always if you have any questions or comments, please write me an Email.

[Email here](#)

Copyright BFSC 2009 [contact webmaster](#)